

Next Day Blinds

Installation Instructions | Savannah Shadings

A Getting Started

The Parts: Before starting, please remove and identify the following parts required for the installation of your shades:

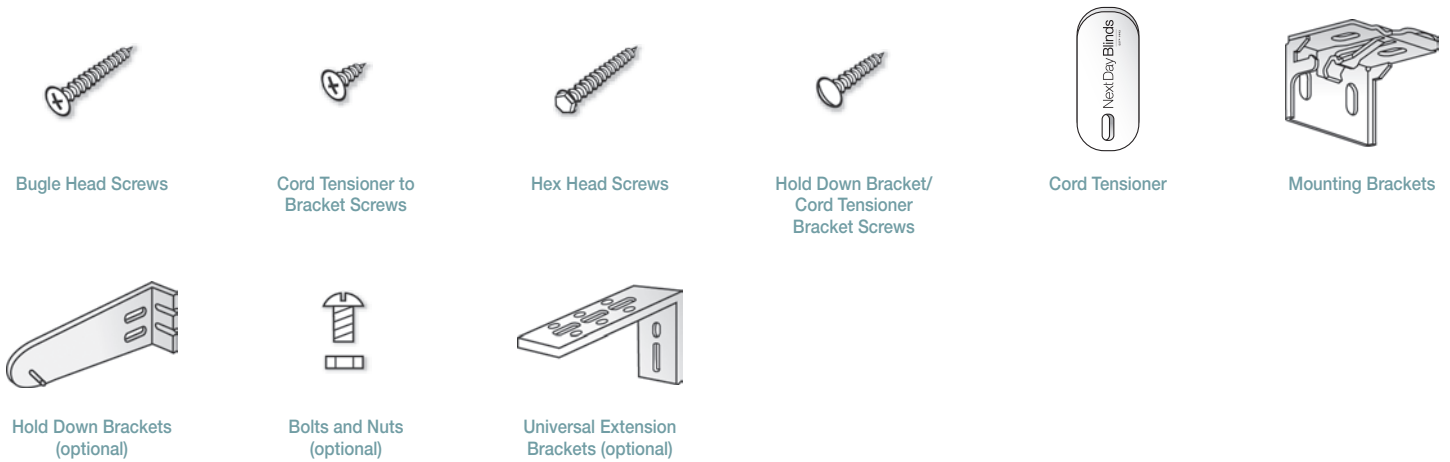

B The Tools

To install your Next Day Blinds Savannah Shadings, you will need a few basic tools:

- Measuring tape
- Power drill with 1/4" hex head attachment and Phillips Head Screwdriver
- Pencil

Important Note: Screws provided are for installation into wooden frames only. For metal surfaces, use suitable sheet metal screws and pre-drill holes. For concrete, stone, brick, or tile, use a carbide drill and appropriate anchors and screws. For wallboard or plaster, use hollow wall anchors and/or longer screws to reach framing or stud. In all cases, follow the fastener manufacturer's recommendations.

C Sorting Your Blinds

On the top of the headrail of your Next Day Blinds Savannah Shadings, there is a sorting label. On this label, you will recognize:

1. Order size of the shade
2. Room location (If not present, info not given at time of order)
3. Whether the shade was ordered for inside mount (IB), outside mount (OB), or side mount (EM)

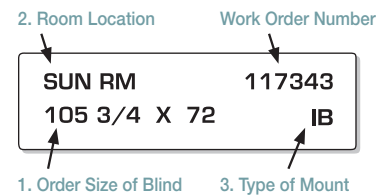

D Bracket Spacing

The brackets should be installed where the centerlines are noted in the illustration. Depending on the width of the shade, necessary additional brackets may be evenly spaced between the two end brackets.

| Shade Width | Number of Brackets |
|-------------|--------------------|
| To 40" | 2 |
| 40" To 72" | 3 |
| 72" To 84" | 4 |
| 84" To 96" | 5 |

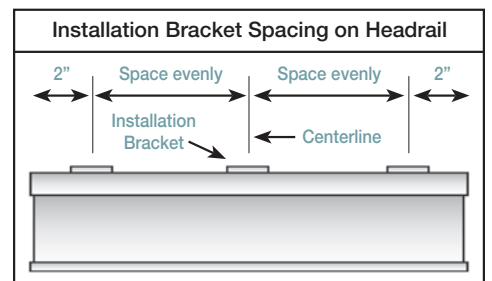

E Bracket Installation

Important Note: Make sure your mounting surface is level. If the headrail does not sit level, the fabric will not roll up evenly which could damage the edges of the fabric.

Inside Mount (IB)

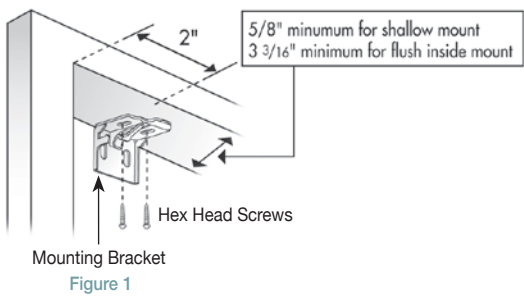

Outside Mount (OB)

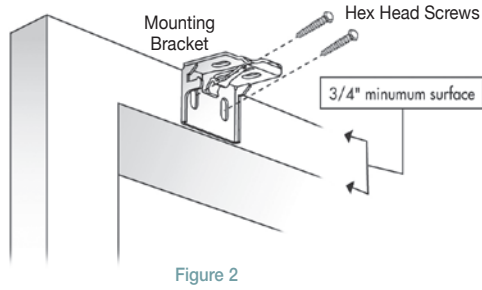

Outside Mount with Extension Brackets (Optional)

Extension Brackets are used to project the back of the shadings up to 2 1/2" from the mounting surface. Attach the Standard Mounting Bracket to the Extension Bracket with the nut and bolt provided (Fig. 4).

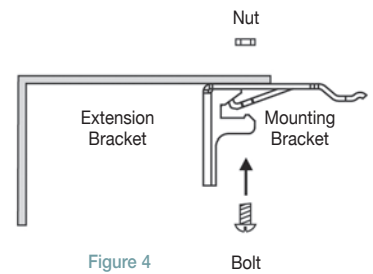
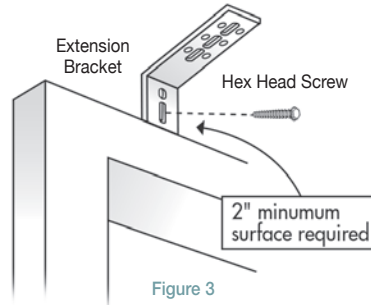

Side Mount (EM)

1. Measure from window sill up to desired mounting position on each side of the window frame. Mark position.
2. Position screw in center of slot so you can adjust position of bracket as necessary.
3. Mount Extension Brackets to each side of window frame as shown (Fig. 5). Make sure to confirm that the headrail will sit perfectly level.
4. Once extension brackets are properly positioned and installed, attached the mounting bracket using the nuts and bolts provided (Fig. 6).

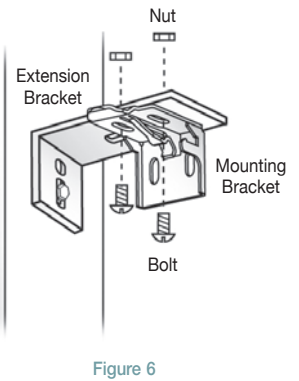
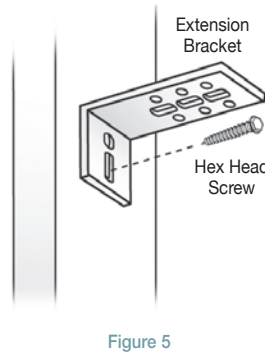

F Installing Your Savannah Shadings into the Brackets

The integrated headrail system used on your Savannah Shading is designed to eliminate the need for a separate snap on valance, and to provide the aesthetic enhancement of concealed brackets.

1. Push the headrail back until it is fully engaged (Fig. 1 and Fig. 2).
2. To remove shading, partially lower the shading and insert a flat head screwdriver as shown (Fig. 3). Twist the screwdriver until the headrail disengages from the bracket.

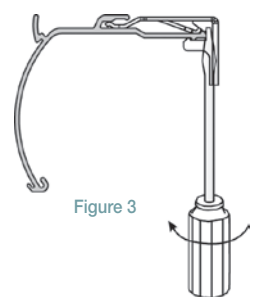
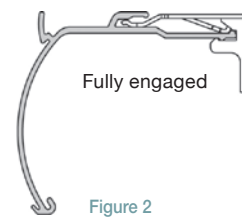
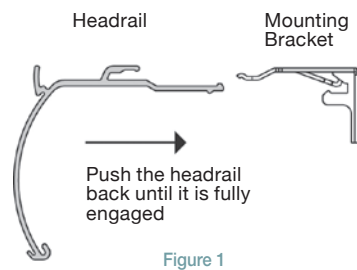

G Cord Tensioner Installation*

1. Lower the shade. Choose one of the three installation methods shown to position the tension device on the window frame or the wall so that the tension device and the control cord do not interfere with shade operation.
2. The control cord must be taut but still operable. Do not allow for any slack. Do not twist or cross the control cord.

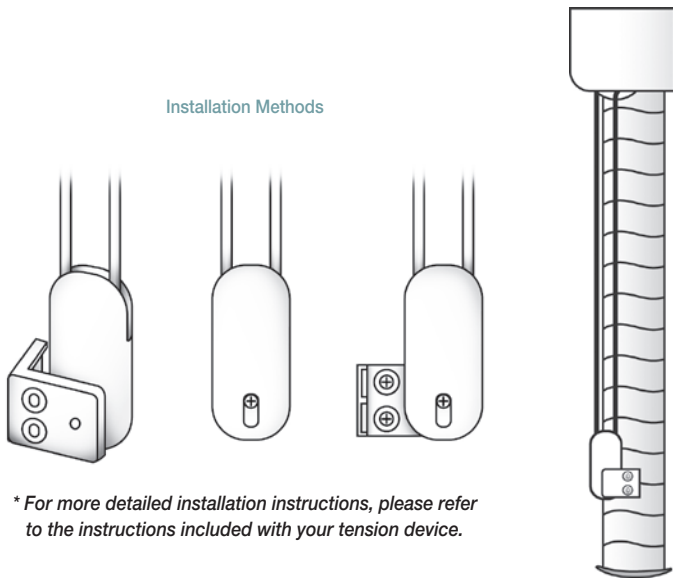

H Hold Down Installation (Optional)

1. Use the pin on the hold down bracket to punch out the front hole on the bottom rail end cap.
2. Mount the hold down to the side or back of the window frame so that the pin lines up with the front hole in the bottom rail end cap with the shade fully lowered and fully open.
3. Lower the shading and flex the hold down bracket outward so that the pin can be inserted into the hole in the end cap.

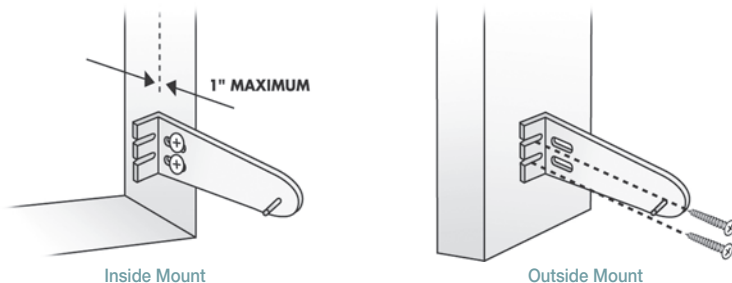

Child Safety

The Consumer Product Safety Commission requires the use of a cord tie down (cord tensioner) on all continuous loop cord systems. The use of such a device is intended to significantly reduce the occurrence of infant or small child strangulation injuries or deaths resulting from the looped pull cords on various window treatment products. The Cord Tensioner is installed on the Lift Cord before packaging. The Tensioning device should be mounted in the proper position to pull the cord taut in order to reduce the possibility of injury.

Cleaning and Care

In order to keep your window treatments looking new, follow the recommended methods for care and maintenance. Regular care will result in better appearance and performance from your window coverings.

www.NextDayBlinds.com | 800.963.9832

| Dusting | Hand-Held Vacuum | Compressed Air | Hair Dryer | Spot Cleaning | Water Immersion | Ultrasonic Cleaning |
|---------|------------------|----------------|------------|---------------|-----------------|---------------------|
| X | X | X | | | | X |
| O | O | O | | | | |

LIGHT FILTERING = X / ROOM DIMMING = O